

MC Single Source Fire Pump Controller

MASTER

Model	Short Circuit Current Rating	Maximum Horsepower				
		200/208	220-240	380/415	440-480	550-600
MCR, MCO MCY, MCT	100,000A	125	150	250*	300	350 300 (MCT)
MCS	100,000A	100	125	200	250	300

* FOR MCO, 250 HP AT 415 VAC, USE ENCLOSURE 20001



Notes:

- Construction:** NEMA Type 2, 12, 3R and 4
- Finish:** Fire Pump Red
- Conduit Entrance:** Conduit Entry on Top or Bottom. Protect Equipment from Drilling Chips
- Conduit Hubs:** Waterproof Hubs Required for Top Entry
- Access:** Front
- Mounting:** Floor Mount
- Shipping Weight:** 650 Lbs. (294.8 kg) Max.

Dimensions In Inches and [Centimeters]

1/2" (13mm) Female N.P.T. Nominal (Trade Size) American Std. Tapered Pipe Thread

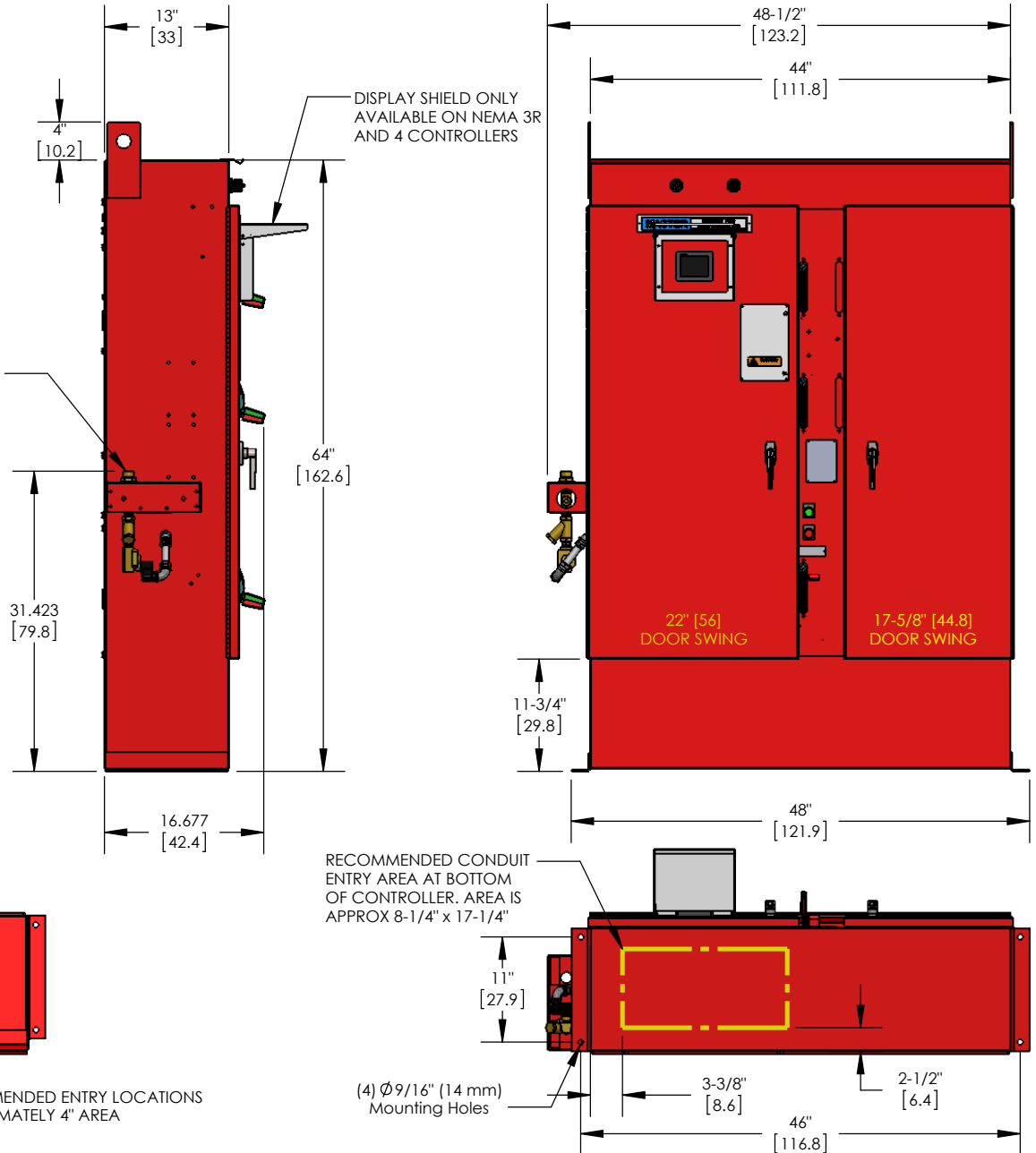

TOP VIEW